

26 980 001 TEMPESTA SYSTEM 250 FLEX SHOWER SYSTEM WITH DIVERTER FOR WALL MOUNTING

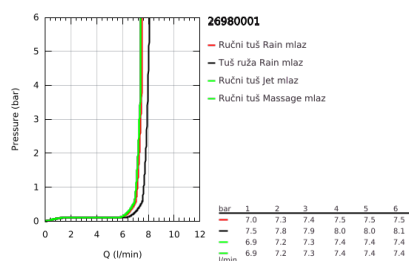
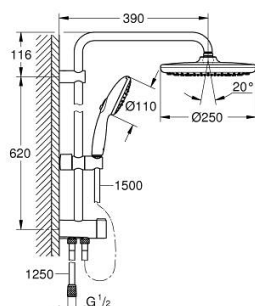

PRODUCT DESCRIPTION (1/2)

- Colour: chrome
- sastoji se od:
 - horizontal 390 mm shower arm, adjustable before installation
 - change by diverter between hand shower, head shower or head shower
- Eco setting
- head shower Tempesta 250 (26 666)
- 2 spray patterns (via diverter):
 - Rain, SmartRain
- head shower with white rear cover
- s kuglastim zglobovom
- rotation angle $\pm 10^\circ$
- hand shower Tempesta 110 (28 419)
- 3 vrste mlaza:
 - Rain, Jet, Massage
- podesiv po visini uz pomoć klizača
- distance between diverter and upper bracket: 620 mm
- Relaxaflex shower hose 1500 mm (28 151)
- Relaxaflex shower hose 1250 mm (28 150)
- flexible installation: connection to faucet / wall union for water supply with 1/2" thread of the 1250 mm shower hose
- maximum flow rate (at 3 bar): 7.9 l/min
- GROHE Water Saving tehnologija za manju potrošnju vode i savršen protok
- GROHE SmartSwitch - easily rotate the dial to enjoy your preferred spray option
- GROHE DreamSpray savršen mlaz iz tuša
- ShockProof silikonski prsten štiti od oštećenja prouzrokovanih padom tuša
- GROHE Long-Life premaz
- SpeedClean sistem protiv kamenca
- Inner WaterGuide za duži životni vek
- prikladno za protočne bojlere od 18 kW/h
- min. brzina protoka 5 l/min.

Pure Freude
an Wasser



26 980 001 **TEMPESTA SYSTEM 250 FLEX SHOWER SYSTEM WITH DIVERTER FOR WALL MOUNTING**

PRODUCT DESCRIPTION (2/2)

- min. preporučeni pritisak 1.0 bar
- professional edition

26 980 001 TEMPESTA SYSTEM 250 FLEX SHOWER SYSTEM WITH DIVERTER FOR WALL MOUNTING

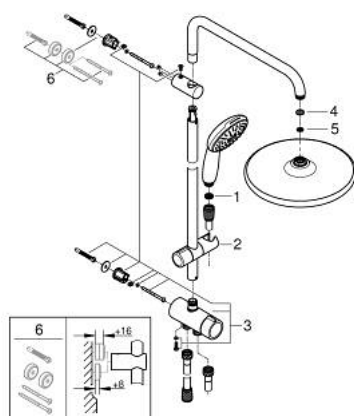

SPARE PARTS, новембар 2021 – now

1: Filter za nečistoću (Spare part-nr. 0700200M)

2: Klizač za tuša (Spare part-nr. 48609000)

3: Prebacivač (Spare part-nr. 48338000)

4: Džet od vlakna poluprečnika Ø18,5 x Ø12 x 2 (Spare part-nr. 0138900M)

5: Filter za nečistoću (Spare part-nr. 48007000)

6: Kompenzaciona ploča (Spare part-nr. 26496000)*

* Optional accessories